

24 Market Place, Bolsover, Chesterfield, S44 6PN  
01246 822 138  
enquiries@wilsonstateagents.co.uk  
www.wilsonstateagents.co.uk



7 Selmer Court  
Chesterfield, Derbyshire S43 1LB

**OFFERS IN THE REGION OF £174,950**

Enjoying a cul-de-sac location this immaculately presented in a neutral colour scheme and spacious throughout, modern three bedroomed semi-detached benefits from off-road parking, detached garage and an enclosed rear garden, designed for low maintenance. Would suit first time buyers or those wishing to 'upsize' alike. The accommodation comprises an entrance hall, dual aspect lounge/diner with patio doors leading out to the rear, modern kitchen, three bedrooms, and a bathroom with a contemporary suite including a corner spa bath. Located in the popular residential area of Brimington, close to local shops and amenities, transport links to Chesterfield and schools.

**7 SELMER COURT, CHESTERFIELD, DERBYSHIRE S43 1LB**



**GROUND FLOOR**  
38.6 sq.m. (415 sq.ft.) approx.

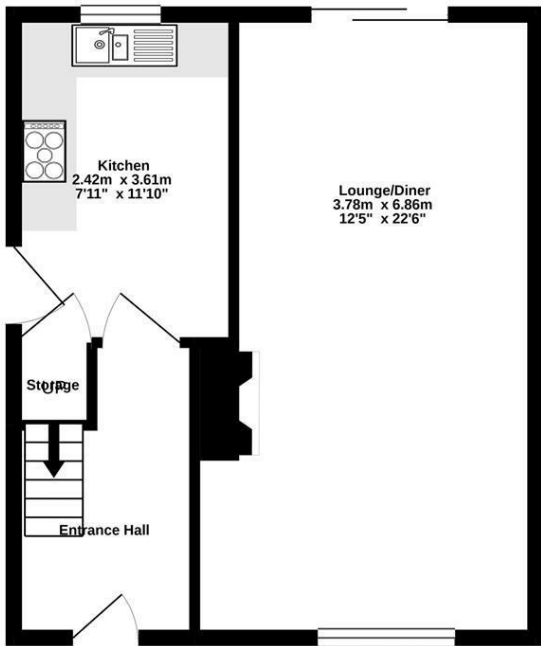

**1ST FLOOR**  
39.4 sq.m. (424 sq.ft.) approx.

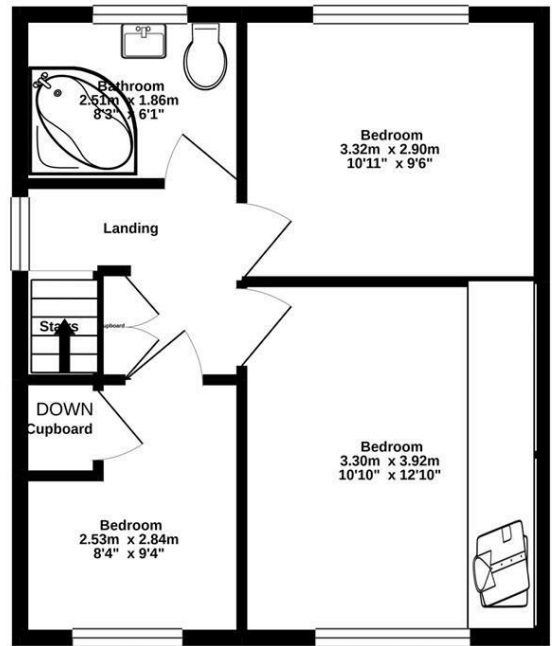

**TOTAL FLOOR AREA : 77.9 sq.m. (839 sq.ft.) approx.**

Whilst every attempt has been made to ensure the accuracy of the floorplan contained here, measurements of doors, windows, rooms and any other items are approximate and no responsibility is taken for any error, omission or mis-statement. This plan is for illustrative purposes only and should be used as such by any prospective purchaser. The services, systems and appliances shown have not been tested and no guarantee as to their operability or efficiency can be given.  
Made with Metropix ©2020

| Energy Efficiency Rating |           | Environmental Impact (CO <sub>2</sub> ) Rating |           |
|--------------------------|-----------|--|-----------|
| Current                  | Potential | Current  | Potential |
| Energy A                 | Energy B  | Env A  | Env B     |
| Energy B                 | Energy C  | Env B  | Env C     |
| Energy C                 | Energy D  | Env C  | Env D     |
| Energy D                 | Energy E  | Env D  | Env E     |
| Energy E                 | Energy F  | Env E  | Env F     |
| Energy F                 | Energy G  | Env F  | Env G     |
| Energy G                 | Energy H  | Env G  | Env H     |
| Energy H                 | Energy I  | Env H  | Env I     |
| Energy I                 | Energy J  | Env I  | Env J     |
| Energy J                 | Energy K  | Env J  | Env K     |
| Energy K                 | Energy L  | Env K  | Env L     |
| Energy L                 | Energy M  | Env L  | Env M     |
| Energy M                 | Energy N  | Env M  | Env N     |
| Energy N                 | Energy O  | Env N  | Env O     |
| Energy O                 | Energy P  | Env O  | Env P     |
| Energy P                 | Energy Q  | Env P  | Env Q     |
| Energy Q                 | Energy R  | Env Q  | Env R     |
| Energy R                 | Energy S  | Env R  | Env S     |
| Energy S                 | Energy T  | Env S  | Env T     |
| Energy T                 | Energy U  | Env T  | Env U     |
| Energy U                 | Energy V  | Env U  | Env V     |
| Energy V                 | Energy W  | Env V  | Env W     |
| Energy W                 | Energy X  | Env W  | Env X     |
| Energy X                 | Energy Y  | Env X  | Env Y     |
| Energy Y                 | Energy Z  | Env Y  | Env Z     |
| Energy Z                 | Energy AA | Env Z  | Env AA    |
| Energy AA                | Energy AB | Env AA   | Env AB    |
| Energy AB                | Energy AC | Env AB   | Env AC    |
| Energy AC                | Energy AD | Env AC   | Env AD    |
| Energy AD                | Energy AE | Env AD   | Env AE    |
| Energy AE                | Energy AF | Env AE   | Env AF    |
| Energy AF                | Energy AG | Env AF   | Env AG    |
| Energy AG                | Energy AH | Env AG   | Env AH    |
| Energy AH                | Energy AI | Env AH   | Env AI    |
| Energy AI                | Energy AJ | Env AI   | Env AJ    |
| Energy AJ                | Energy AK | Env AJ   | Env AK    |
| Energy AK                | Energy AL | Env AK   | Env AL    |
| Energy AL                | Energy AM | Env AL   | Env AM    |
| Energy AM                | Energy AN | Env AM   | Env AN    |
| Energy AN                | Energy AO | Env AN   | Env AO    |
| Energy AO                | Energy AP | Env AO   | Env AP    |
| Energy AP                | Energy AQ | Env AP   | Env AQ    |
| Energy AQ                | Energy AR | Env AQ   | Env AR    |
| Energy AR                | Energy AS | Env AR   | Env AS    |
| Energy AS                | Energy AT | Env AS   | Env AT    |
| Energy AT                | Energy AU | Env AT   | Env AU    |
| Energy AU                | Energy AV | Env AU   | Env AV    |
| Energy AV                | Energy AW | Env AV   | Env AW    |
| Energy AW                | Energy AX | Env AW   | Env AX    |
| Energy AX                | Energy AY | Env AX   | Env AY    |
| Energy AY                | Energy AZ | Env AY   | Env AZ    |
| Energy AZ                | Energy BA | Env AZ   | Env BA    |
| Energy BA                | Energy BB | Env BA   | Env BB    |
| Energy BB                | Energy BC | Env BB   | Env BC    |
| Energy BC                | Energy BD | Env BC   | Env BD    |
| Energy BD                | Energy BE | Env BD   | Env BE    |
| Energy BE                | Energy BF | Env BE   | Env BF    |
| Energy BF                | Energy BG | Env BF   | Env BG    |
| Energy BG                | Energy BH | Env BG   | Env BH    |
| Energy BH                | Energy BI | Env BH   | Env BI    |
| Energy BI                | Energy BJ | Env BI   | Env BJ    |
| Energy BJ                | Energy BK | Env BJ   | Env BK    |
| Energy BK                | Energy BL | Env BK   | Env BL    |
| Energy BL                | Energy BM | Env BL   | Env BM    |
| Energy BM                | Energy BN | Env BM   | Env BN    |
| Energy BN                | Energy BO | Env BN   | Env BO    |
| Energy BO                | Energy BP | Env BO   | Env BP    |
| Energy BP                | Energy BQ | Env BP   | Env BQ    |
| Energy BQ                | Energy BR | Env BQ   | Env BR    |
| Energy BR                | Energy BS | Env BR   | Env BS    |
| Energy BS                | Energy BT | Env BS   | Env BT    |
| Energy BT                | Energy BU | Env BT   | Env BU    |
| Energy BU                | Energy BV | Env BU   | Env BV    |
| Energy BV                | Energy BW | Env BV   | Env BW    |
| Energy BW                | Energy BX | Env BW   | Env BX    |
| Energy BX                | Energy BY | Env BX   | Env BY    |
| Energy BY                | Energy BZ | Env BY   | Env BZ    |
| Energy BZ                | Energy CA | Env BZ   | Env CA    |
| Energy CA                | Energy CB | Env CA   | Env CB    |
| Energy CB                | Energy CC | Env CB   | Env CC    |
| Energy CC                | Energy CD | Env CC   | Env CD    |
| Energy CD                | Energy CE | Env CD   | Env CE    |
| Energy CE                | Energy CF | Env CE   | Env CF    |
| Energy CF                | Energy CG | Env CF   | Env CG    |
| Energy CG                | Energy CH | Env CG   | Env CH    |
| Energy CH                | Energy CI | Env CH   | Env CI    |
| Energy CI                | Energy CJ | Env CI   | Env CJ    |
| Energy CJ                | Energy CK | Env CJ   | Env CK    |
| Energy CK                | Energy CL | Env CK   | Env CL    |
| Energy CL                | Energy CM | Env CL   | Env CM    |
| Energy CM                | Energy CN | Env CM   | Env CN    |
| Energy CN                | Energy CO | Env CN   | Env CO    |
| Energy CO                | Energy CP | Env CO   | Env CP    |
| Energy CP                | Energy CQ | Env CP   | Env CQ    |
| Energy CQ                | Energy CR | Env CQ   | Env CR    |
| Energy CR                | Energy CS | Env CR   | Env CS    |
| Energy CS                | Energy CT | Env CS   | Env CT    |
| Energy CT                | Energy CU | Env CT   | Env CU    |
| Energy CU                | Energy CV | Env CU   | Env CV    |
| Energy CV                | Energy CW | Env CV   | Env CW    |
| Energy CW                | Energy CX | Env CW   | Env CX    |
| Energy CX                | Energy CY | Env CX   | Env CY    |
| Energy CY                | Energy CZ | Env CY   | Env CZ    |
| Energy CZ                | Energy DA | Env CZ   | Env DA    |
| Energy DA                | Energy DB | Env DA   | Env DB    |
| Energy DB                | Energy DC | Env DB   | Env DC    |
| Energy DC                | Energy DD | Env DC   | Env DD    |
| Energy DD                | Energy DE | Env DD   | Env DE    |
| Energy DE                | Energy DF | Env DE   | Env DF    |
| Energy DF                | Energy DG | Env DF   | Env DG    |
| Energy DG                | Energy DH | Env DG   | Env DH    |
| Energy DH                | Energy DI | Env DH   | Env DI    |
| Energy DI                | Energy DJ | Env DI   | Env DJ    |
| Energy DJ                | Energy DK | Env DJ   | Env DK    |
| Energy DK                | Energy DL | Env DK   | Env DL    |
| Energy DL                | Energy DM | Env DL   | Env DM    |
| Energy DM                | Energy DN | Env DM   | Env DN    |
| Energy DN                | Energy DO | Env DN   | Env DO    |
| Energy DO                | Energy DP | Env DO   | Env DP    |
| Energy DP                | Energy DQ | Env DP   | Env DQ    |
| Energy DQ                | Energy DR | Env DQ   | Env DR    |
| Energy DR                | Energy DS | Env DR   | Env DS    |
| Energy DS                | Energy DT | Env DS   | Env DT    |
| Energy DT                | Energy DU | Env DT   | Env DU    |
| Energy DU                | Energy DV | Env DV   | Env DV    |
| Energy DV                | Energy DW | Env DV   | Env DW    |
| Energy DW                | Energy DX | Env DW   | Env DX    |
| Energy DX                | Energy DY | Env DX   | Env DY    |
| Energy DY                | Energy DZ | Env DY   | Env DZ    |
| Energy DZ                | Energy EA | Env DZ   | Env EA    |
| Energy EA                | Energy EB | Env EA   | Env EB    |
| Energy EB                | Energy EC | Env EB   | Env EC    |
| Energy EC                | Energy ED | Env EC   | Env ED    |
| Energy ED                | Energy EE | Env ED   | Env EE    |
| Energy EE                | Energy EF | Env EE   | Env EF    |
| Energy EF                | Energy EG | Env EF   | Env EG    |
| Energy EG                | Energy EH | Env EG   | Env EH    |
| Energy EH                | Energy EI | Env EH   | Env EI    |
| Energy EI                | Energy EJ | Env EI   | Env EJ    |
| Energy EJ                | Energy EK | Env EJ   | Env EK    |
| Energy EK                | Energy EL | Env EK   | Env EL    |
| Energy EL                | Energy EM | Env EL   | Env EM    |
| Energy EM                | Energy EN | Env EM   | Env EN    |
| Energy EN                | Energy EO | Env EN   | Env EO    |
| Energy EO                | Energy EP | Env EO   | Env EP    |
| Energy EP                | Energy EQ | Env EP   | Env EQ    |
| Energy EQ                | Energy ER | Env EQ   | Env ER    |
| Energy ER                | Energy ES | Env ER   | Env ES    |
| Energy ES                | Energy ET | Env ES   | Env ET    |
| Energy ET                | Energy EU | Env ET   | Env EU    |
| Energy EU                | Energy EV | Env EU   | Env EV    |
| Energy EV                | Energy EW | Env EV   | Env EW    |
| Energy EW                | Energy EX | Env EW   | Env EX    |
| Energy EX                | Energy EY | Env EX   | Env EY    |
| Energy EY                | Energy EZ | Env EY   | Env EZ    |
| Energy EZ                | Energy FA | Env EZ   | Env FA    |
| Energy FA                | Energy FB | Env FA   | Env FB    |
| Energy FB                | Energy FC | Env FB   | Env FC    |
| Energy FC                | Energy FD | Env FC   | Env FD    |
| Energy FD                | Energy FE | Env FD   | Env FE    |
| Energy FE                | Energy FF | Env FE   | Env FF    |
| Energy FF                | Energy FG | Env FF   | Env FG    |
| Energy FG                | Energy FH | Env FG   | Env FH    |
| Energy FH                | Energy FI | Env FH   | Env FI    |
| Energy FI                | Energy FJ | Env FI   | Env FJ    |
| Energy FJ                | Energy FK | Env FJ   | Env FK    |
| Energy FK                | Energy FL | Env FK   | Env FL    |
| Energy FL                | Energy FM | Env FL   | Env FM    |
| Energy FM                | Energy FN | Env FM   | Env FN    |
| Energy FN                | Energy FO | Env FN   | Env FO    |
| Energy FO                | Energy FP | Env FO   | Env FP    |
| Energy FP                | Energy FQ | Env FP   | Env FQ    |
| Energy FQ                | Energy FR | Env FQ   | Env FR    |
| Energy FR                | Energy FS | Env FR   | Env FS    |
| Energy FS                | Energy FT | Env FS   | Env FT    |
| Energy FT                | Energy FU | Env FT   | Env FU    |
| Energy FU                | Energy FV | Env FU   | Env FV    |
| Energy FV                | Energy FW | Env FV   | Env FW    |
| Energy FW                | Energy FX | Env FW   | Env FX    |
| Energy FX                | Energy FY | Env FX   | Env FY    |
| Energy FY                | Energy FZ | Env FY   | Env FZ    |
| Energy FZ                | Energy GA | Env FZ   | Env GA    |
| Energy GA                | Energy GB | Env GA   | Env GB    |
| Energy GB                | Energy GC | Env GB   | Env GC    |
| Energy GC                | Energy GD | Env GC   | Env GD    |
| Energy GD                | Energy GE | Env GD   | Env GE    |
| Energy GE                | Energy GF | Env GE   | Env GF    |
| Energy GF                | Energy GG | Env GF   | Env GG    |
| Energy GG                | Energy GH | Env GG   | Env GH    |
| Energy GH                | Energy GI | Env GH   | Env GI    |
| Energy GI                | Energy GJ | Env GI   | Env GJ    |
| Energy GJ                | Energy GK | Env GJ   | Env GK    |
| Energy GK                | Energy GL | Env GK   | Env GL    |
| Energy GL                | Energy GM | Env GL   | Env GM    |
| Energy GM                | Energy GN | Env GM   | Env GN    |
| Energy GN                | Energy GO | Env GN   | Env GO    |
| Energy GO                | Energy GP | Env GO   | Env GP    |
| Energy GP                | Energy GQ | Env GP   | Env GQ    |
| Energy GQ                | Energy GR | Env GQ   | Env GR    |
| Energy GR                | Energy GS | Env GR   | Env GS    |
| Energy GS                | Energy GT | Env GS   | Env GT    |
| Energy GT                | Energy GU | Env GT   | Env GU    |
| Energy GU                | Energy GV | Env GU   | Env GV    |
| Energy GV                | Energy GW | Env GV   | Env GW    |
| Energy GW                | Energy GX | Env GW   | Env GX    |
| Energy GX                | Energy GY | Env GX   | Env GY    |
| Energy GY                | Energy GZ | Env GY   | Env GZ    |
| Energy GZ                | Energy HA | Env GZ   | Env HA    |
| Energy HA                | Energy HB | Env HA   | Env HB    |
| Energy HB                | Energy HC | Env HB   | Env HC    |
| Energy HC                | Energy HD | Env HC   | Env HD    |
| Energy HD                | Energy HE | Env HD   | Env HE    |
| Energy HE                | Energy HF | Env HE   | Env HF    |
| Energy HF                | Energy HG | Env HF   | Env HG    |
| Energy HG                | Energy HH | Env HG   | Env HH    |
| Energy HH                | Energy HI | Env HH   | Env HI    |
| Energy HI                | Energy HJ | Env HI   | Env HJ    |
| Energy HJ                | Energy HK | Env HJ   | Env HK    |
| Energy HK                | Energy HL | Env HK   | Env HL    |
| Energy HL                | Energy HM | Env HL   | Env HM    |
| Energy HM                | Energy HN | Env HM   | Env HN    |
| Energy HN                | Energy HO | Env HN   | Env HO    |
| Energy HO                | Energy HP | Env HO   | Env HP    |
| Energy HP                | Energy HQ | Env HP   | Env HQ    |
| Energy HQ                | Energy HR | Env HQ   | Env HR    |
| Energy HR                | Energy HS | Env HR   | Env HS    |
| Energy HS                | Energy HT | Env HS   | Env HT    |
| Energy HT                | Energy HU | Env HT   | Env HU    |
| Energy HU                | Energy HV | Env HU   | Env HV    |
| Energy HV                | Energy HW | Env HV   | Env HW    |
| Energy HW                | Energy HX | Env HW   | Env HX    |
| Energy HX                | Energy HY | Env HX   | Env HY    |
| Energy HY                | Energy HZ | Env HY   | Env HZ    |
| Energy HZ                | Energy IA | Env HZ   | Env IA    |
| Energy IA                | Energy IB | Env IA   | Env IB    |
| Energy IB                | Energy IC | Env IB   | Env IC    |
| Energy IC                | Energy ID | Env IC   | Env ID    |
| Energy ID                | Energy IE | Env ID   | Env IE    |
| Energy IE                | Energy IF | Env IE   | Env IF    |
| Energy IF                | Energy IG | Env IF   | Env IG    |
| Energy IG                | Energy IH | Env IG   | Env IH    |
| Energy IH                | Energy II | Env IH   | Env II    |
| Energy II                | Energy IJ | Env II   | Env IJ    |
| Energy IJ                | Energy IK | Env IJ   | Env IK    |
| Energy IK                | Energy IL | Env IK   | Env IL    |
| Energy IL                | Energy IM | Env IL   | Env IM    |
| Energy IM                | Energy IN | Env IM   | Env IN    |
| Energy IN                | Energy IO | Env IN   | Env IO    |
| Energy IO                | Energy IP | Env IO   | Env IP    |
| Energy IP                | Energy IQ | Env IP   | Env IQ    |
| Energy IQ                | Energy IR | Env IQ   | Env IR    |
| Energy IR                | Energy IS | Env IR   | Env IS    |
| Energy IS                | Energy IT | Env IS   | Env IT    |
| Energy IT                | Energy IU | Env IT   | Env IU    |
| Energy IU                | Energy IV | Env IU   | Env IV    |
| Energy IV                | Energy IW | Env IV   | Env IW    |
| Energy IW                | Energy IX | Env IW   | Env IX    |
| Energy IX                | Energy IY | Env IX   | Env IY    |
| Energy IY                | Energy IZ | Env IY   | Env IZ    |
| Energy IZ                | Energy JA | Env IZ   | Env JA    |
| Energy JA                | Energy JB | Env JA   | Env JB    |
| Energy JB                | Energy JC | Env JB   | Env JC    |
| Energy JC                | Energy JD | Env JC   | Env JD    |
| Energy JD                | Energy JE | Env JD   | Env JE    |
| Energy JE                | Energy JF | Env JE   | Env JF    |
| Energy JF                | Energy JG | Env JF   | Env JG    |
| Energy JG                | Energy JH | Env JG   | Env JH    |
| Energy JH                | Energy JI | Env JH   | Env JI    |
| Energy JI                | Energy JJ | Env JI   | Env JJ    |
| Energy JJ                | Energy JK | Env JJ   | Env JK    |
| Energy JK                | Energy JL | Env JK   | Env JL    |
| Energy JL                | Energy JM | Env JL   | Env JM    |
| Energy JM                | Energy JN | Env JM   | Env JN    |
| Energy JN                | Energy JO | Env JN   | Env JO    |
| Energy JO                | Energy JP | Env JO   | Env JP    |
| Energy JP                | Energy JQ | Env JP   | Env JQ    |
| Energy JQ                | Energy JR | Env JQ   | Env JR    |
| Energy JR                | Energy JS | Env JR   | Env JS    |
| Energy JS                | Energy JT | Env JS   | Env JT    |
| Energy JT                | Energy JU | Env JT   | Env JU    |
| Energy JU                | Energy JV | Env JU   | Env JV    |
| Energy JV                | Energy JW | Env JV   | Env JW    |
| Energy JW                | Energy JX | Env JW   | Env JX    |
| Energy JX                | Energy JY | Env JX   | Env JY    |
| Energy JY                | Energy JZ | Env JY   | Env JZ    |
| Energy JZ                | Energy KA | Env JZ   | Env KA    |
| Energy KA                | Energy KB | Env KA   | Env KB    |
| Energy KB                | Energy KC | Env KB   | Env KC    |
| Energy KC                | Energy KD | Env KC   | Env KD    |
| Energy KD                | Energy KE | Env KD   | Env KE    |
| Energy KE                | Energy KF | Env KE   | Env KF    |
|                          |           |  |           |