

24 Market Place, Bolsover, Chesterfield, S44 6PN  
01246 822 138  
enquiries@wilsonstateagents.co.uk  
www.wilsonstateagents.co.uk



2 Woodthorpe Close  
Chesterfield, Derbyshire S44 6RE

**OFFERS IN THE REGION OF £169,950**

**\*NO CHAIN\* \*DETACHED GARAGE\* \*JUST MOVE IN & UNPACK\*** Enjoying a semi-rural location and situated in a quiet cul-de-sac with good commuting links to the M1 and the nearby town of Chesterfield, this beautifully presented two bedroomed semi-detached bungalow benefits from a newly fitted kitchen with built-in AEG appliances, a spacious lounge with a feature fireplace, two bedrooms with fitted bedroom furniture and a bathroom with recently installed, modern three piece suite. Having gardens to front and rear, a driveway providing ample off road parking which leads to a detached garage which has light and power. The property also benefits from a newly installed gas boiler and partial re-wire.

## 2 WOODTHORPE CLOSE, CHESTERFIELD, DERBYSHIRE S44 6RE



**GROUND FLOOR**  
56.3 sq.m. (606 sq.ft.) approx.

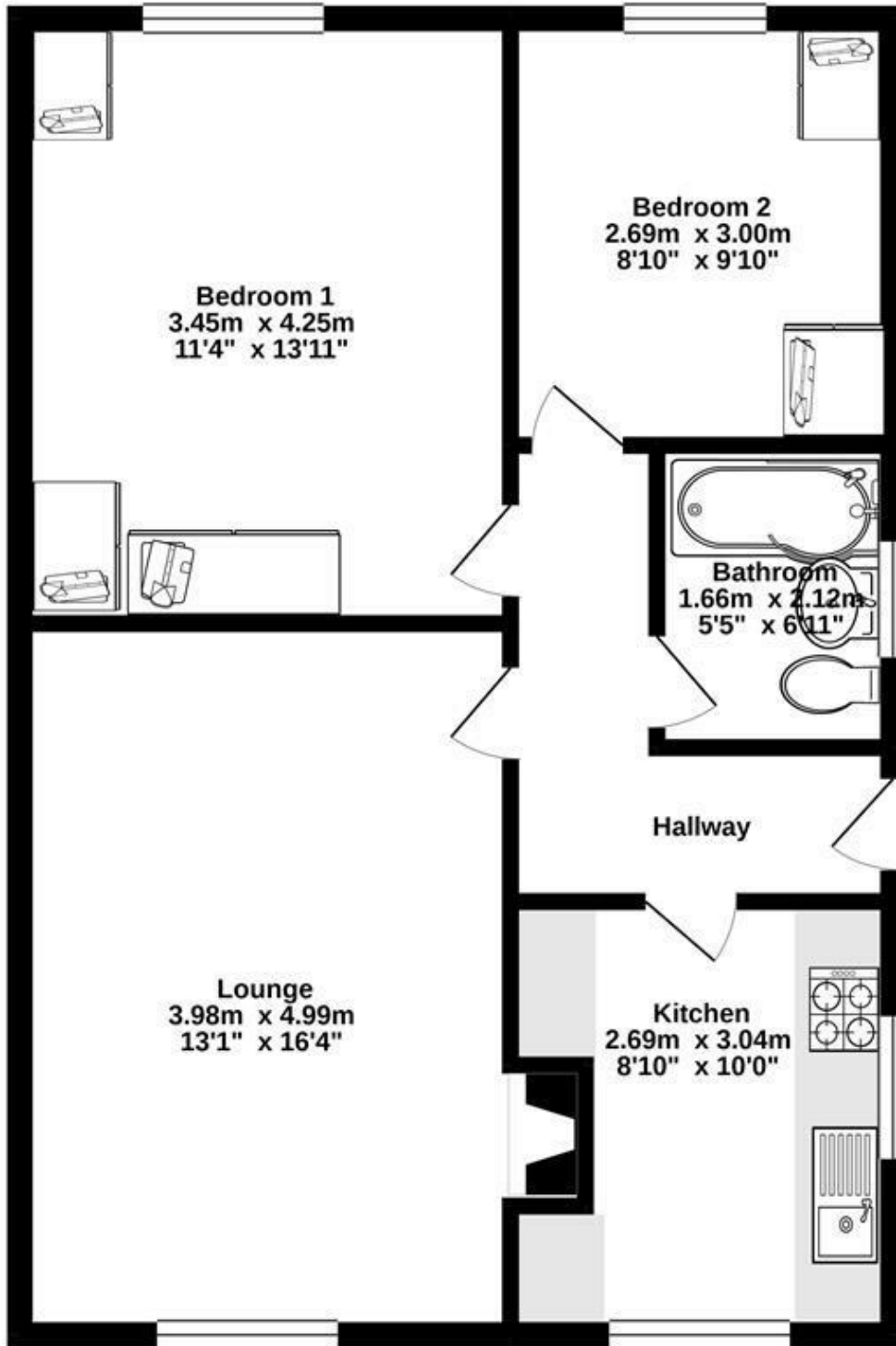

**TOTAL FLOOR AREA : 56.3 sq.m. (606 sq.ft.) approx.**

Whilst every attempt has been made to ensure the accuracy of the floorplan contained here, measurements of doors, windows, rooms and any other items are approximate and no responsibility is taken for any error, omission or mis-statement. This plan is for illustrative purposes only and should be used as such by any prospective purchaser. The services, systems and appliances shown have not been tested and no guarantee as to their operability or efficiency can be given.

Made with Metropix ©2021

