

24 Market Place, Bolsover, Chesterfield, S44 6PN
01246 822 138
enquiries@wilsonstateagents.co.uk
www.wilsonstateagents.co.uk



238 Victoria Street
Chesterfield, Derbyshire S44 6LG

OFFERS IN THE REGION OF £114,950

IDEAL STARTER HOME / INVESTMENT OPPORTUNITY Well presented throughout, deceptively spacious mid terrace property comprising two reception rooms, a modern kitchen with under floor heating, cellar, two bedrooms and a contemporary four piece bathroom with double shower cubicle. There is an attic room to the third floor currently being used as the master bedroom. Outside sees a low maintenance, enclosed rear garden with raised decked seating area. The property also benefits from a security alarm system. Ideally situated for commuting to the M1 via J29a Markham Vale and the nearby towns of Chesterfield and Mansfield.

238 VICTORIA STREET, CHESTERFIELD, DERBYSHIRE S44 6LG

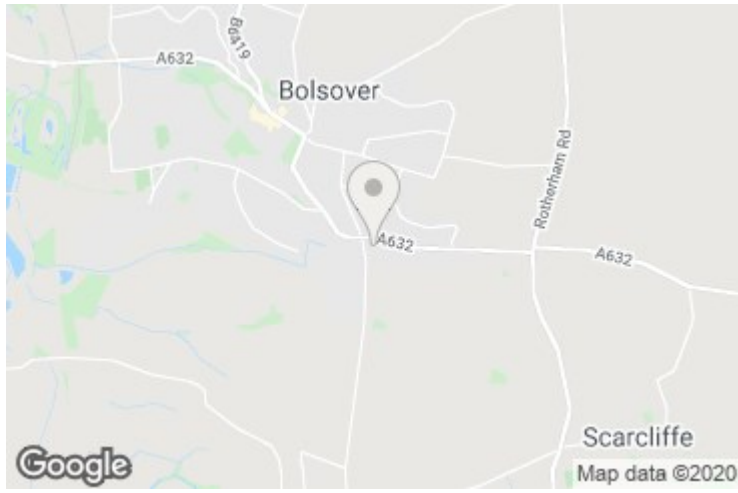

GROUND FLOOR
40.1 sq.m. (431 sq.ft.) approx.

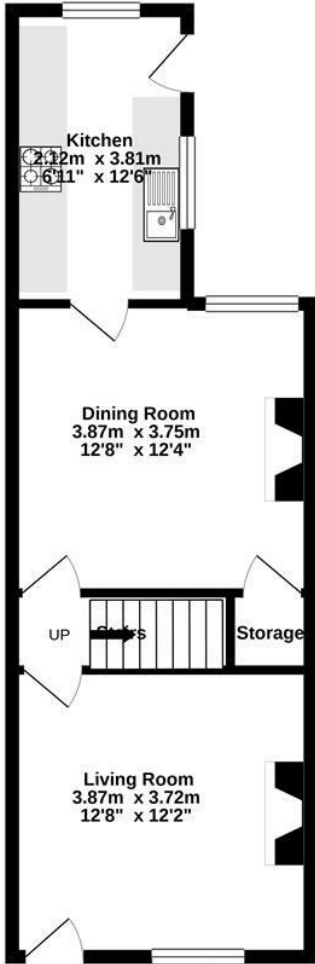

1ST FLOOR
32.5 sq.m. (350 sq.ft.) approx.

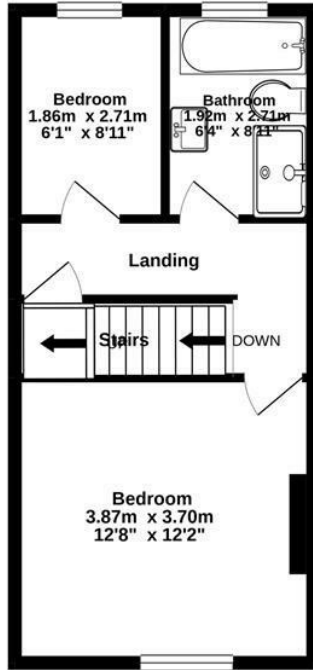

ATTIC ROOM
22.3 sq.m. (240 sq.ft.) approx.



TOTAL FLOOR AREA : 94.9 sq.m. (1021 sq.ft.) approx.

Whilst every attempt has been made to ensure the accuracy of the floorplan contained here, measurements of doors, windows, rooms and any other items are approximate and no responsibility is taken for any error, omission or mis-statement. This plan is for illustrative purposes only and should be used as such by any prospective purchaser. The services, systems and appliances shown have not been tested and no guarantee as to their operability or efficiency can be given.
Made with Metropix ©2020

Energy Efficiency Rating		Environmental Impact (CO ₂) Rating	
Current	Potential	Current	Potential
Energy A	Energy A	Env Impact B	Env Impact B
Energy B	Energy B	Env Impact C	Env Impact C
Energy C	Energy C	Env Impact D	Env Impact D
Energy D	Energy D	Env Impact E	Env Impact E
Energy E	Energy E	Env Impact F	Env Impact F
Energy F	Energy F	Env Impact G	Env Impact G
Energy G	Energy G	Env Impact H	Env Impact H

For energy efficient, higher rating assets.
England & Wales
2020/11/16
2020/11/16