

24 Market Place, Bolsover, Chesterfield, S44 6PN  
01246 822 138  
enquiries@wilsonstateagents.co.uk  
www.wilsonstateagents.co.uk



23 Rhodes Cottages  
Chesterfield, Derbyshire S43 4LZ

**OFFERS IN THE REGION OF £84,950**

**\*NO CHAIN\*** Lovely, three bedroomed mid property that would appeal to first time buyers and investors alike, offering deceptively spacious, well presented accommodation throughout comprising two reception rooms, kitchen, two double bedrooms, a single bedroom and bathroom. The property is ideally located for accessing the M1 via J30 and has good commuting links to Chesterfield and Mansfield.

## 23 RHODES COTTAGES, CHESTERFIELD, DERBYSHIRE S43 4LZ



GROUND FLOOR  
39.1 sq.m. (421 sq.ft.) approx.



1ST FLOOR  
34.6 sq.m. (372 sq.ft.) approx.

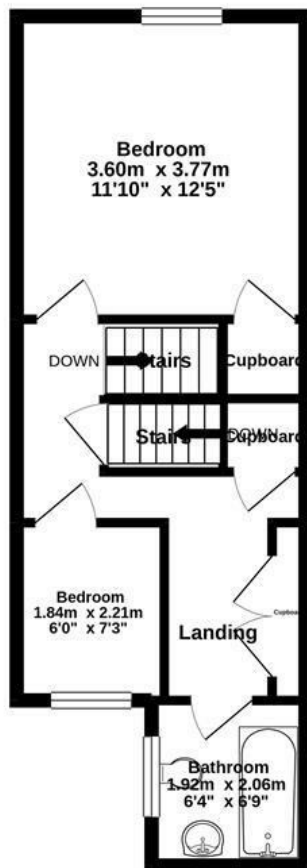

2ND FLOOR  
14.2 sq.m. (152 sq.ft.) approx.

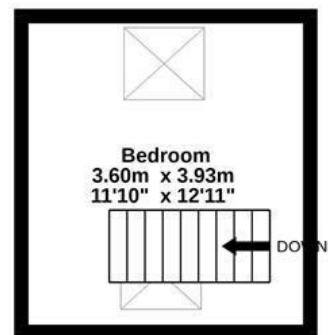

TOTAL FLOOR AREA : 87.9 sq.m. (946 sq.ft.) approx.

Whilst every attempt has been made to ensure the accuracy of the floorplan contained here, measurements of doors, windows, rooms and any other items are approximate and no responsibility is taken for any error, omission or mis-statement. This plan is for illustrative purposes only and should be used as such by any prospective purchaser. The services, systems and appliances shown have not been tested and no guarantee as to their operability or efficiency can be given.  
Made with Metropix ©2021

Energy Efficiency Rating	Score	Details
Very Energy Efficient (Super Low Energy Build)		
Energy A		
Energy B		
Energy C		
Energy D		
Energy E		
Energy F		
Energy G		
Very Energy Efficient (Super Low Energy Build)		
England & Wales		

Environmental Impact (CO <sub>2</sub> ) Rating	Score	Details
Very Environmentally Friendly (Lower CO <sub>2</sub> emissions)		
Environment A		
Environment B		
Environment C		
Environment D		
Environment E		
Environment F		
Environment G		
Very Environmentally Friendly (Lower CO <sub>2</sub> emissions)		
England & Wales		